

SLTP 3-POSITION HANDLE

Installation Instructions and Parts Guide

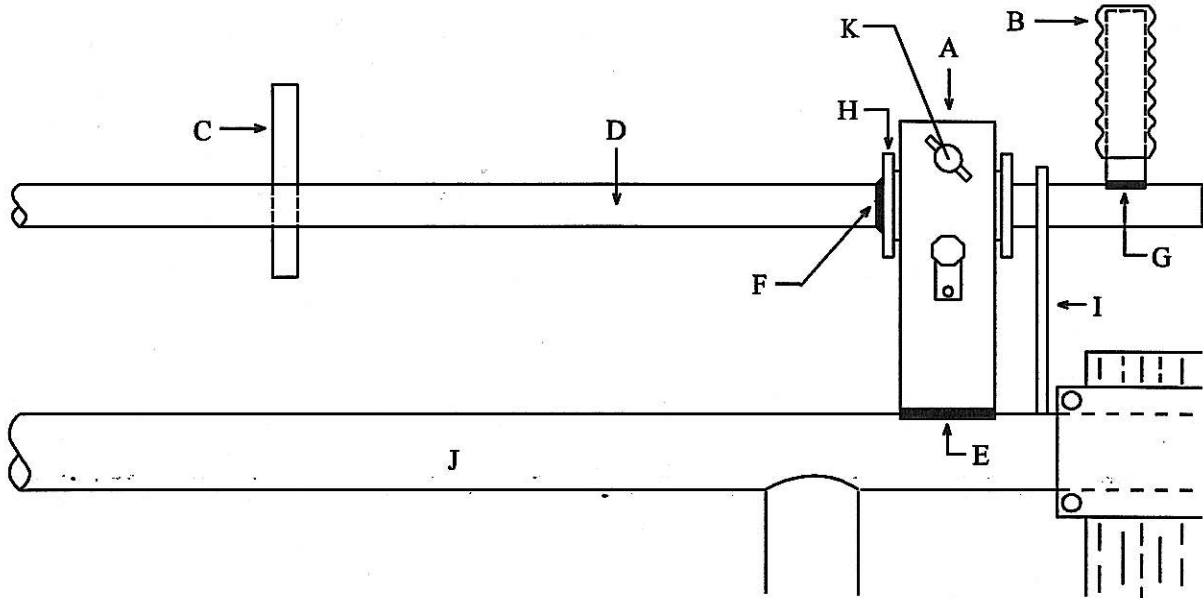

Parts Guide

- A. Main Body Handle Bracket
- B. Turn Handle with Plastic Grip
- H. Locking Mandrel (Square bracket with washers each end)
- K. Lock Pin

Installation Instructions

1. Insert top rail (D) in top rail guides (I) - (swedge end toward panel end in direction heads swing open for top entry).
2. Place main body handle bracket (A), with mandrel (H) inserted, vertically on top of main frame horizontal rail (J) as shown.
3. Insert top locking rail (D) through the locking mandrel (H) in the handle bracket.
4. Weld handle bracket (A) to horizontal rail (J) at (E). Place as close to post clamp as possible.
5. Rotate top rail (D) with spring pin (C) to vertical position as shown. Slide top rail side to side until the spring pin is in the center of the locking flaps while holding the movable locking head in a vertical, upright (closed) position (equal distance at top and bottom from stationary pipe).
6. Weld top rail (D) to mandrel washer (H) at (F) as shown.
7. With the control rail (D) in the locking position (locking spring pin down), weld handle stub (B) in a vertical position at (G).
8. Follow procedure five (5) for installing the remainder of panels in the continuous run, welding the top rail at the swedge joints after positioning (weld on both sides opposite of each other to maintain proper alignment)..